

RP63Z

55x55 mm frontal buttons secured on plates 1.5-2 and 3 mm thick through release tabs, with zamak and polycarbonate plates in various colours and finishes.

They come complete with bright 8-28V LED indicator, change-over contact with long-life microswitch, C-clamps and 2 mm travel.

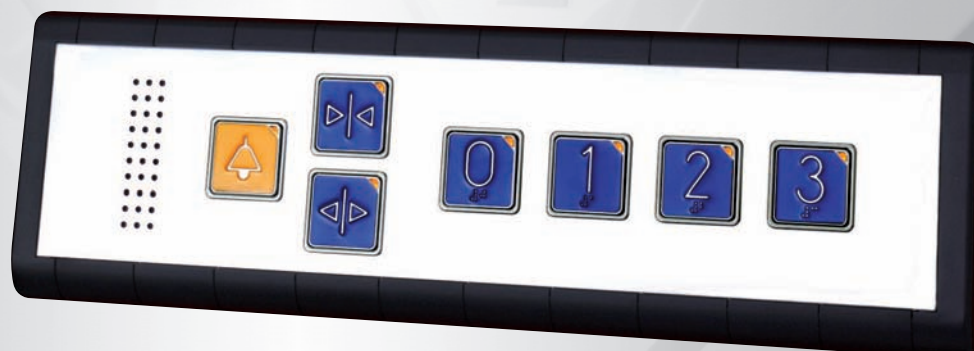



FEATURES

Structure: Self-extinguishing ABS push button

Frame: Chrome-plated zama

Shiny chrome
Satin chrome
Satin nickel-plated
Shiny gold
Satin gold

Assembly: Front snaps on with connectors.

Plate thickness: From 1mm to 3mm.

Contact: Microswitch - 24V I=20mA
1NO
1NO/1NC
2NO/2NC

Power Supply: 1 Led, 9/30V.

Lighting:



Push button travel: 1mm

Protection rating: IP50

Wiring: Connector terminals. Screw terminal

External RP63 Push Button Dimensions

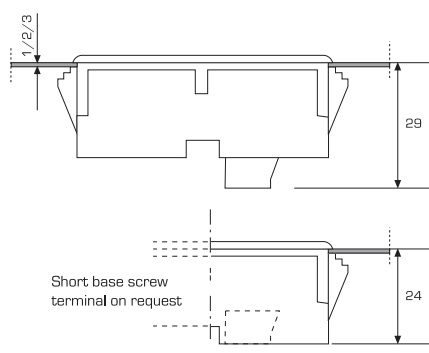

(seen from below)

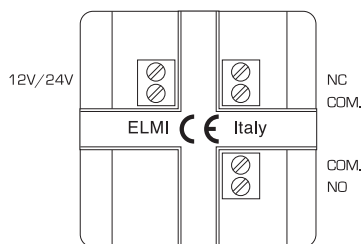

electrical connection

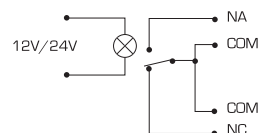

hole dimension on plate

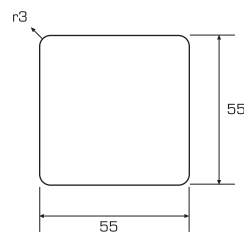

Type of Plates matched for push button/indication



Polycarbonate with negative symbol for indications



Zama printed with Braille